

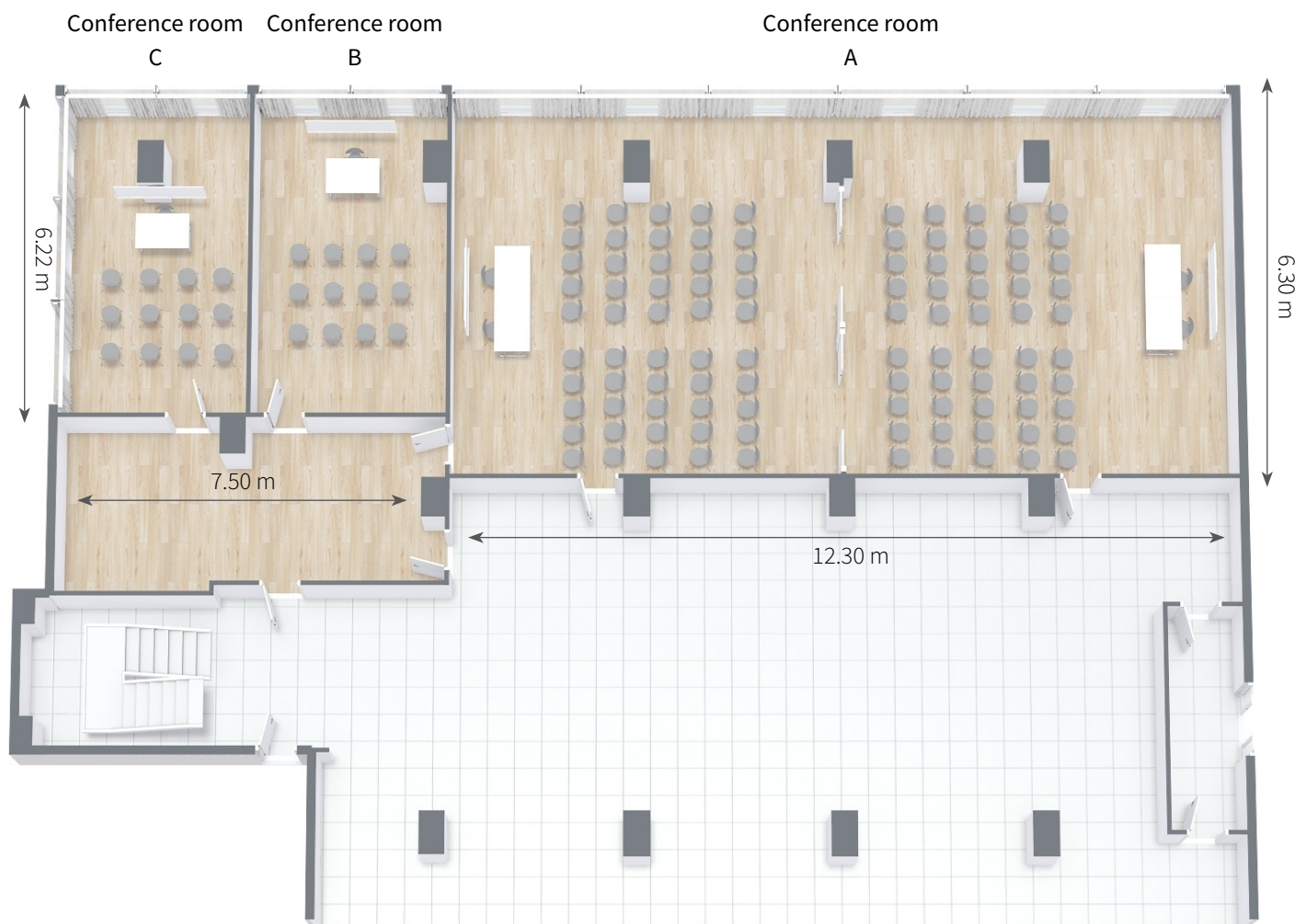

Sunprime Coral Suites & Spa

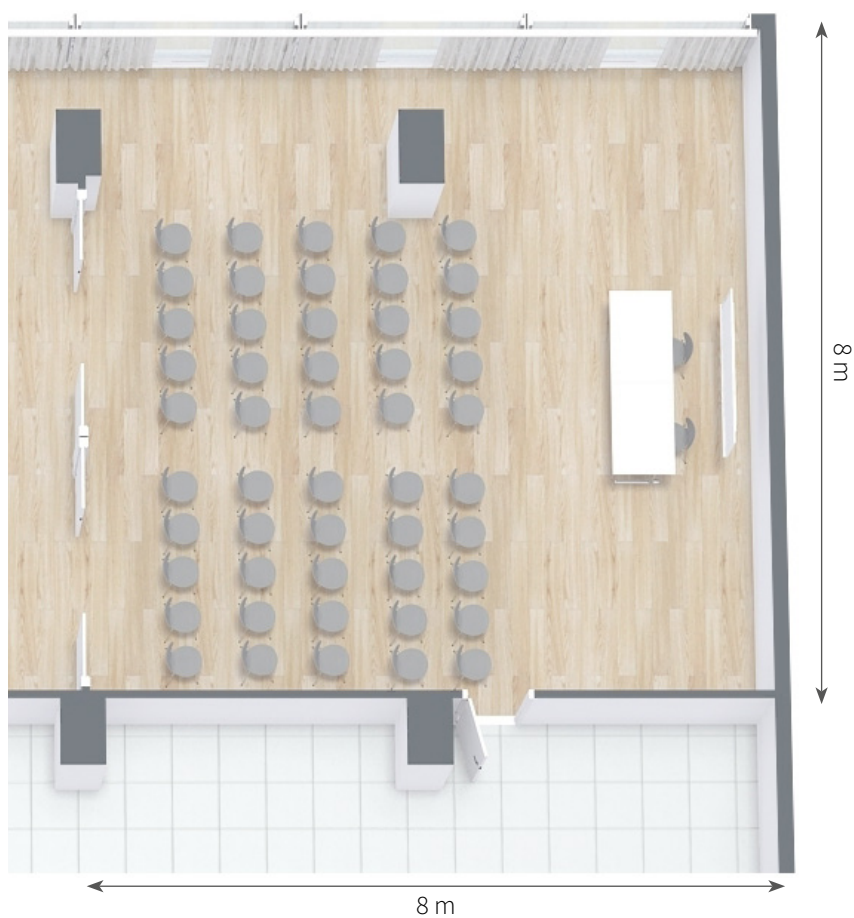





Conference room A50

- AREA:** 65 m²
- A/C:** Yes
- HEATING:** No
- WINDOWS:** Yes
- HEIGHT:** 3.10 m
- CAPACITY CLASSROOM:** 30
- CAPACITY THEATRE:** 50
- CAPACITY U-SEATING:** 25
- SLIDING WALLS:** Yes
- BLACKOUT CURTAINS:** Yes

Equipment

- INTERNET:** Yes
- TELEPHONE:** No
- WHITEBOARD:** Yes
- FLIPCHART:** Yes
- PROJECTOR:** Yes
- SCREEN:** Yes
- LOUD SPEAKERS:** On request



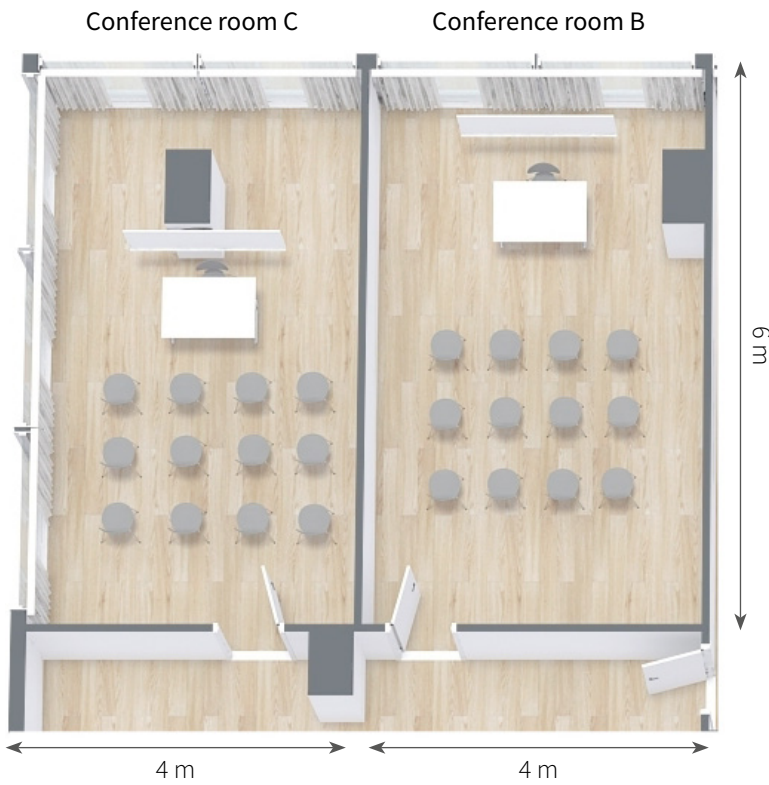

Conference room C12 + D12

AREA: 25 m²

A/C: Yes

HEATING: No

WINDOWS: Yes

HEIGHT: 3.10 m

CAPACITY CLASSROOM: –

CAPACITY THEATRE: –

CAPACITY U-SEATING: 12

SLIDING WALLS: No

BLACKOUT CURTAINS: Yes

Equipment

INTERNET: Yes

TELEPHONE: Yes

WHITEBOARD: Yes

FLIPCHART: Yes

PROJECTOR: Yes

SCREEN: Yes

LOUD SPEAKERS: No

